

# INSTALLATION INSTRUCTIONS FOR

## EWC W\M EXTENDED CONSTELLATION WITH CONSTELLATION CISTERN



S. No.	Catalogue No.	Item Description
1.	20028 & 21038	EWC W\M Extended Constellation with Constellation Cistern.

### RECOMMENDED STANDARD SPECIFICATION TABLE FOR EWC W\M EXTENDED CONSTELLATION WITH CISTERN CONSTELLATION

Sr. No.	Cat. No.	Description	Dist. Between centre of fixing bolt (A)	Dist. Between centre line of fixing bolt to centre of outlet (B)	Dist. from face of outlet to wall
1.	20028 & 21038	EWC W\M Extended Constellation with Constellation Cistern.	200 mm $\pm$ 10 mm	190 mm $\pm$ 5 mm	25 mm



hindware

## STEPS FOR INSTALLATION

1

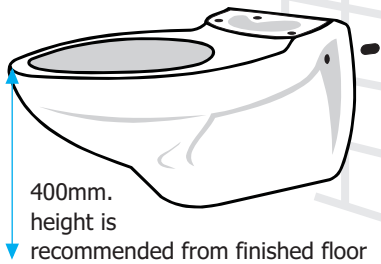

400mm.  
height is  
recommended from finished floor

Grout bracket chair / bolts of 12mm Ø at a distance of (A) in the wall such that the height of front rim up to floor should be 400mm & Bolt should be projected 70 mm from finished wall .

The recommended bolt dia is 12 mm in which chrome plated cap can be tightened at the end.

2

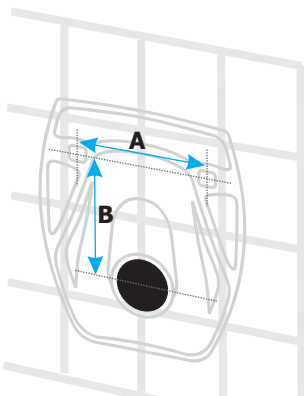

Fix the rag bolt with the help of sleeves & The outlet hole in the wall should be made as mentioned in (B).

(It is recommended to match the hole with EWC physically)

4

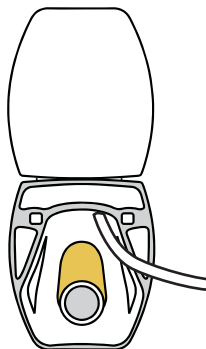

Connect the flexible pipe for incoming water at the bottom of beta valve.

3 All the fitting components should be fitted as mentioned below.

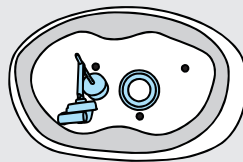

i) Fit the bottom inlet ball valve in the inlet hole of Constellation Cistern.

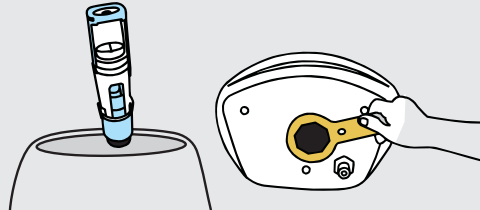

ii) Fit the beta valve tail pc in the central outlet hole & tight the check nut at the bottom of Cistern.

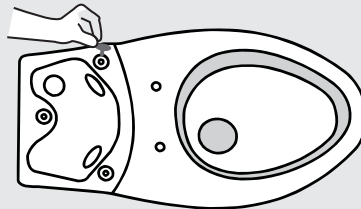

iii) Put the rubber of rubberized bolt inside all the three holes of extended part of EWC.

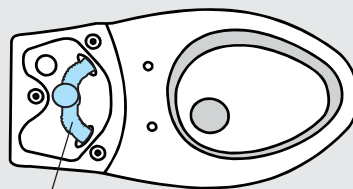

iv) Insert the diverter pipe inside the back side of EWC and outlet of diverter pipe should be in the center such that front mark should be in front



v) Place the Cistern with matching the hole of cistern & insert the outlet of diverter inside beta valve hole & tight the brass bolt in all the three holes from inside the cistern with screw driver.

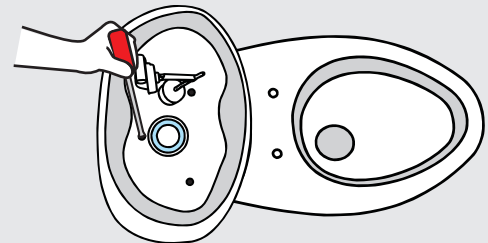

vi) Fit the beta valve into the tail pc and dual flush knob on lid & screw with the beta valve bracket for the fitment of lid on cistern shell.

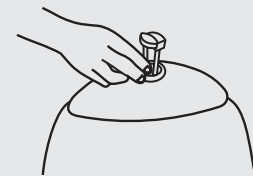

vii) Put both the buttons (6L/3L) inside the dual flush.

5



Put the outlet rubber gasket in the outlet to fit in waste outlet. It is suggested to fit the seat cover before installation. Fit the W/M Ext. EWC in the bolts (fitted inside wall) & tight the same & put chrome plated cap on the bolts.

6

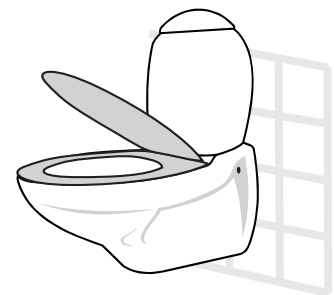

Note:- The float can be adjusted up or down for the desired water level.



# hindware